

Q1:

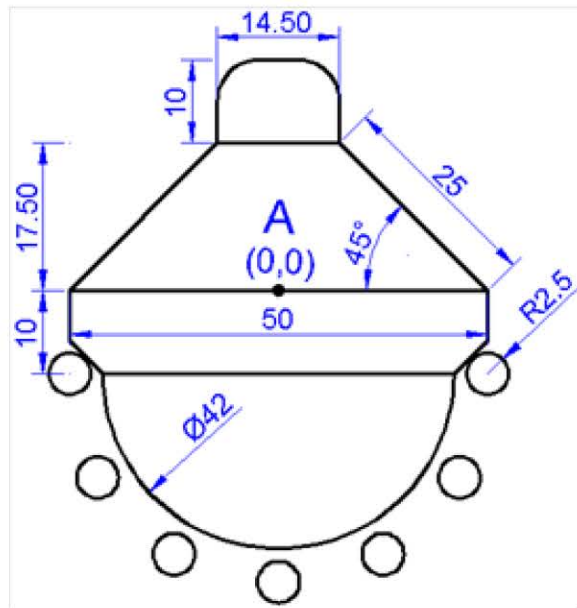

Command: LINE Specify first point: 0,0
Specify next point or [Undo]: 25,0 "first line"
Specify next point or [Undo]: @25<135 "second line"
Specify next point or [Close/Undo]: @10<90 "third line"
Specify next point or [Close/Undo]: @7.5<180 "fourth line"
Specify next point or [Close/Undo]: *Cancel* "press ESC"

Command: **OFFSET**

Current settings: Erase source=No Layer=Source OFFSETGAPTYPE=0

Specify offset distance or [Through/Erase/Layer] <Through>: 10

Select object to offset or [Exit/Undo] <Exit>: select the first line

Specify point on side to offset or [Exit/Multiple/Undo] <Exit>: click downwards the line

Select object to offset or [Exit/Undo] <Exit>: select the fourth line

Specify point on side to offset or [Exit/Multiple/Undo] <Exit>: click downwards the line

Select object to offset or [Exit/Undo] <Exit>: *Cancel*

Command: **FILLET**
Current settings: Mode = TRIM, Radius = 0.0000
Select first object or [Undo/Polyline/Radius/Trim/Multiple]: r Specify fillet radius <10.0000>: 5
Select first object or [Undo/Polyline/Radius/Trim/Multiple]: select the third line
Select second object or shift-select to apply corner: select the fourth line

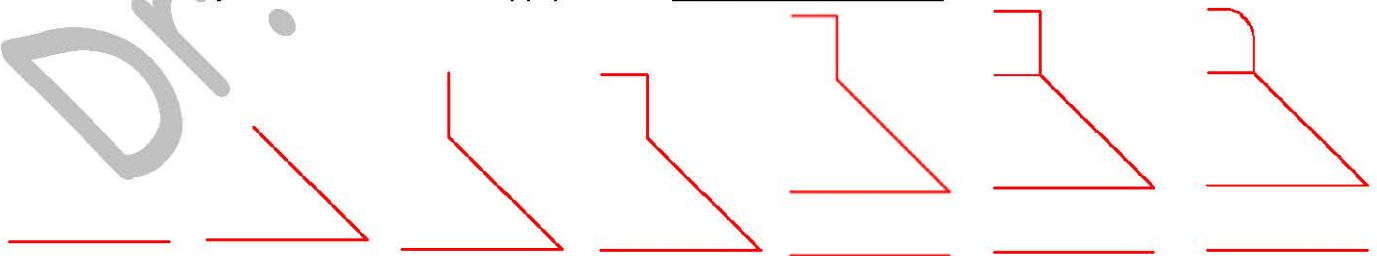

Command: LINE Specify first point: 25,0
Specify next point or [Undo]: @10<-90 "fifth line"
Specify next point or [Undo]: *Cancel*

Command: CHAMFER
(TRIM mode) Current chamfer Dist1 = 0.0000, Dist2 = 0.0000

Select first line or [Undo/Polyline/Distance/Angle/Trim/mEthod/Multiple]: d
Specify first chamfer distance <0.0000>: 4 Specify second chamfer distance <4.0000>: press Enter
Select first line or [Undo/Polyline/Distance/Angle/Trim/mEthod/Multiple]: select the offset of the first line
Select second line or shift-select to apply corner: select the fifth line
Command: MIRROR
Select objects: select all the lines: 7 found
Select objects: Specify first point of mirror line: 0,0
Specify second point of mirror line: 0,17.5
Erase source objects? [Yes/No] <N>: press Enter

Command: CIRCLE Specify center point for circle or [3P/2P/Ttr (tan tan radius)]: 0,-10
Specify radius of circle or [Diameter]: 21

Command: TRIM
Current settings: Projection=UCS, Edge=Extend
Select cutting edges ...
Select objects or <select all>: select the offset of the first line: 1 found
Select objects: select its mirror line: 1 found, 2 total
Select objects: press Enter
Select object to trim or shift-select to extend or [Fence/Crossing/Project/Edge/eRase/Undo]: select the upper side of the first circle
Select object to trim or shift-select to extend or [Fence/Crossing/Project/Edge/eRase/Undo]: *Cancel*

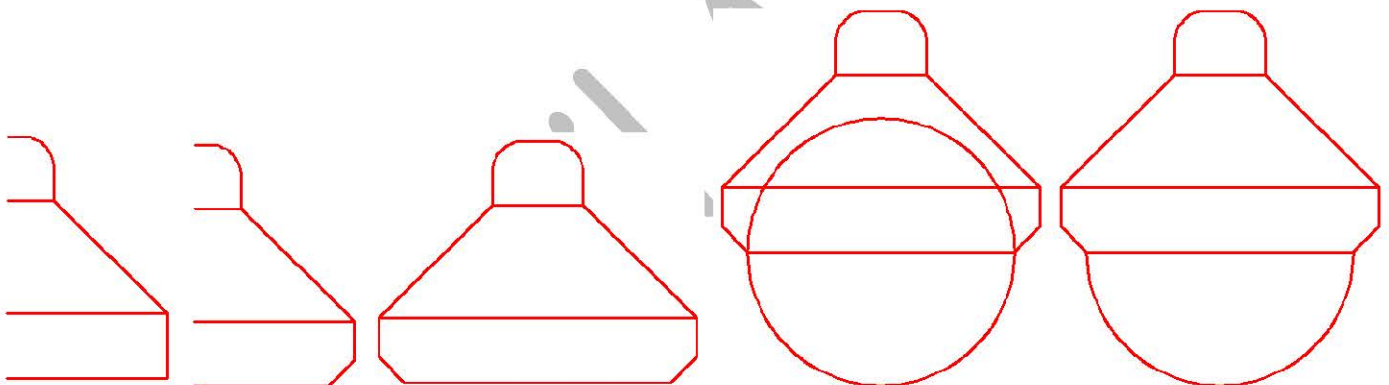

Command: CIRCLE Specify center point for circle or [3P/2P/Ttr (tan tan radius)]: 25,-10
Specify radius of circle or [Diameter] <21.0000>: 2.5

Command: ARRAY
Select Polar array
Select objects: select second circle: 1 found
Specify center point of array: select point (0,-10)
Total number of items: 7
Angle to fill: -180
"press OK"

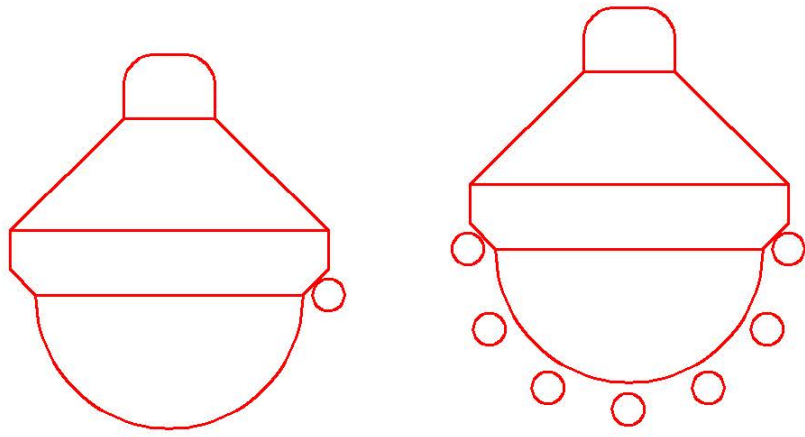

Q2:

